

REGISTER SEARCH STATEMENT (Title Search) Transfer of Land Act 1958

Page 1 of 1

VOLUME 08667 FOLIO 023

Security no : 124110478028Q
Produced 14/11/2023 10:30 AM

LAND DESCRIPTION

Lot 6 on Plan of Subdivision 076251.
PARENT TITLE Volume 08133 Folio 042
Created by instrument LP076251 28/04/1967

REGISTERED PROPRIETOR

Estate Fee Simple
Joint Proprietors
MARGARET LYNN LAVERY
SHAUN LAVERY both of 134 LANGTON ROAD HOWARD SPRINGS NT 0835
AX028138S 10/07/2023

ENCUMBRANCES, CAVEATS AND NOTICES

Any encumbrances created by Section 98 Transfer of Land Act 1958 or Section 24 Subdivision Act 1988 and any other encumbrances shown or entered on the plan or imaged folio set out under DIAGRAM LOCATION below.

DIAGRAM LOCATION

SEE LP076251 FOR FURTHER DETAILS AND BOUNDARIES

ACTIVITY IN THE LAST 125 DAYS

NIL

-----END OF REGISTER SEARCH STATEMENT-----

Additional information: (not part of the Register Search Statement)

Street Address: 9 MATHESON STREET BOLWARRA VIC 3305

ADMINISTRATIVE NOTICES

NIL

eCT Control 15070S SOUTH WEST CONVEYANCING
Effective from 10/07/2023

DOCUMENT END



Imaged Document Cover Sheet

The document following this cover sheet is an imaged document supplied by LANDATA®, Secure Electronic Registries Victoria.

Document Type	Plan
Document Identification	LP076251
Number of Pages (excluding this cover sheet)	2
Document Assembled	27/10/2023 11:15

Copyright and disclaimer notice:

© State of Victoria. This publication is copyright. No part may be reproduced by any process except in accordance with the provisions of the Copyright Act 1968 (Cth) and for the purposes of Section 32 of the Sale of Land Act 1962 or pursuant to a written agreement. The information is only valid at the time and in the form obtained from the LANDATA® System. None of the State of Victoria, LANDATA®, Secure Electronic Registries Victoria Pty Ltd (ABN 86 627 986 396) as trustee for the Secure Electronic Registries Victoria Trust (ABN 83 206 746 897) accept responsibility for any subsequent release, publication or reproduction of the information.

The document is invalid if this cover sheet is removed or altered.

LP76251
EDITION 1
APPROVED 30/3/67

PLAN OF SUBDIVISION OF
PARTS OF CROWN ALLOTMENTS 20 & 21
PARISH OF BOLWARRA
COUNTY OF NORMANBY

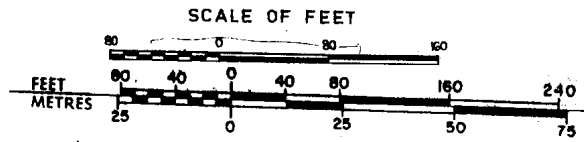

COLOUR CONVERSION
E-1=BROWN

13

Balance of land in
C/T. Vol. 8133 Fol. 042
excepting land in
L.P. 32685

Lot 13 is encumbered vide
C/T. Vol. 8133 Fol. 042. and
Instrument No. 2569361.

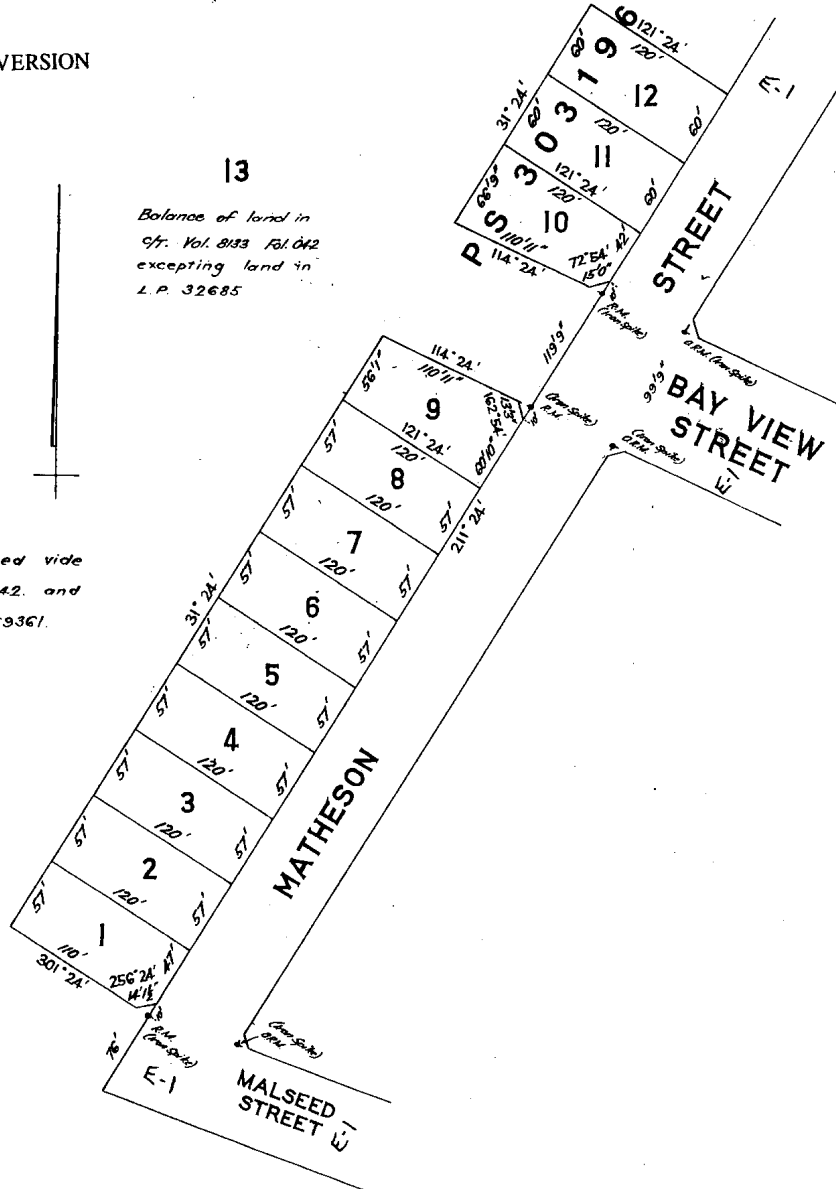

FOR APPROPRIATIONS, ETC.
SEE BACK HEREOF

CERTIFICATE OF TITLE V. 8133 F. 042

LODGED BY NICOL SILVESTER & CO.

DATE 30.12.66

DECLARED BY A. O. WILLIAMS 2.11.66

CONSENT OF COUNCIL SHIRE OF
PORTLAND

9.12.66

PLAN APPROVED DATE 30.3.67 TIME 12.07

THE LAND COLOURED **BROWN**
IS APPROPRIATED
OR SET APART FOR
EASEMENTS OF **WAY.**

LP 76.251.....
BACK OF SHEET ...!.....

PARCELS INDEX

BOLWARRA.....

LOT 13 IS ENCUMBERED
VIDE CIT #8133 F. 042
AND INSTRUMENT 2569361

STREET NAME AMENDED
FROM DUTTON ST TO MALSEED ST CORR.
VIDE GAZ. 1971 PAGE 1129

[Signature]
ASSISTANT REGISTRAR OF TITLES
- 4 JUN 1971