

**REGISTER SEARCH STATEMENT (Title Search) Transfer of
Land Act 1958**

Page 1 of 1

VOLUME 10473 FOLIO 222

Security no : 124124095646G
Produced 01/05/2025 03:27 PM

LAND DESCRIPTION

Crown Allotment 8 Section 10 Township of Casterton Parish of Casterton.
Created by Application No. 100310B 15/09/1999

REGISTERED PROPRIETOR

Estate Fee Simple
Sole Proprietor

THE UNITING CHURCH IN AUSTRALIA PROPERTY TRUST (VICTORIA) of LEVEL 2 WESLEY
PLACE 130 LONSDALE STREET MELBOURNE VIC 3000

ENCUMBRANCES, CAVEATS AND NOTICES

For details of any other encumbrances see the plan or imaged folio set out
under DIAGRAM LOCATION below.

DIAGRAM LOCATION

SEE TP014846A FOR FURTHER DETAILS AND BOUNDARIES

ACTIVITY IN THE LAST 125 DAYS

NIL

-----END OF REGISTER SEARCH STATEMENT-----

Additional information: (not part of the Register Search Statement)

Street Address: 176 HENTY STREET CASTERTON VIC 3311

DOCUMENT END

REGISTER SEARCH STATEMENT (Title Search) Transfer of Land Act 1958

Page 1 of 1

VOLUME 10473 FOLIO 221

Security no : 124124095536C
Produced 01/05/2025 03:26 PM

LAND DESCRIPTION

Crown Allotment 7 Section 10 Township of Casterton Parish of Casterton.
Created by Application No. 100310B 15/09/1999

REGISTERED PROPRIETOR

Estate Fee Simple

Sole Proprietor

THE UNITING CHURCH IN AUSTRALIA PROPERTY TRUST (VICTORIA) of LEVEL 2 WESLEY
PLACE 130 LONSDALE STREET MELBOURNE VIC 3000

ENCUMBRANCES, CAVEATS AND NOTICES

For details of any other encumbrances see the plan or imaged folio set out
under DIAGRAM LOCATION below.

DIAGRAM LOCATION

SEE TP014846A FOR FURTHER DETAILS AND BOUNDARIES

ACTIVITY IN THE LAST 125 DAYS

NIL

-----END OF REGISTER SEARCH STATEMENT-----

Additional information: (not part of the Register Search Statement)

Street Address: 176 HENTY STREET CASTERTON VIC 3311

DOCUMENT END

**REGISTER SEARCH STATEMENT (Title Search) Transfer of
Land Act 1958**

Page 1 of 1

VOLUME 10473 FOLIO 220

Security no : 124124095437J
Produced 01/05/2025 03:24 PM

LAND DESCRIPTION

Lot 1 on Title Plan 014846A.
Created by Application No. 100310B 15/09/1999

REGISTERED PROPRIETOR

Estate Fee Simple
Sole Proprietor

THE UNITING CHURCH IN AUSTRALIA PROPERTY TRUST (VICTORIA) of LEVEL 2 WESLEY
PLACE 130 LONSDALE STREET MELBOURNE VIC 3000

ENCUMBRANCES, CAVEATS AND NOTICES

Any encumbrances created by Section 98 Transfer of Land Act 1958 or Section
24 Subdivision Act 1988 and any other encumbrances shown or entered on the
plan set out under DIAGRAM LOCATION below.

DIAGRAM LOCATION

SEE TP014846A FOR FURTHER DETAILS AND BOUNDARIES

ACTIVITY IN THE LAST 125 DAYS

NIL

-----END OF REGISTER SEARCH STATEMENT-----

Additional information: (not part of the Register Search Statement)

Street Address: 176 HENTY STREET CASTERTON VIC 3311

DOCUMENT END

TITLE PLAN

EDITION 1

TP14846A

LOCATION OF LAND

PARISH : CASTERTON
TOWNSHIP : CASTERTON
SECTION : 10
CROWN ALLOTMENT : 6 (PT), 7 (WH) & 8 (WH).
CROWN PORTION :

LTO BASE RECORD : SDMB-C (RURAL)
LAST PLAN REFERENCE :
TITLE REFERENCE :

DEPTH LIMITATION : NIL

NOTATIONS

Warning as to dimensions

Any dimension and connecting distance shown is based on the description of the land as contained in the General Law Title and is not based on survey information which has been investigated by the Registrar of Titles.

Note: Warning applies to lot 1 only.

EASEMENT INFORMATION

Easement Reference	Purpose / Authority	Width (Metres)	Origin	Land benefitted / in favour of
NIL				

Legend : A - Appurtenant E : Encumbering Easement R : Encumbering Easement (Road)

THIS PLAN HAS BEEN
PREPARED BY LAND
REGISTRY, LAND VICTORIA
FOR TITLE DIAGRAM PURPOSES

Checked by

Date 18/ 2 / 09

Assistant Registrar of Titles

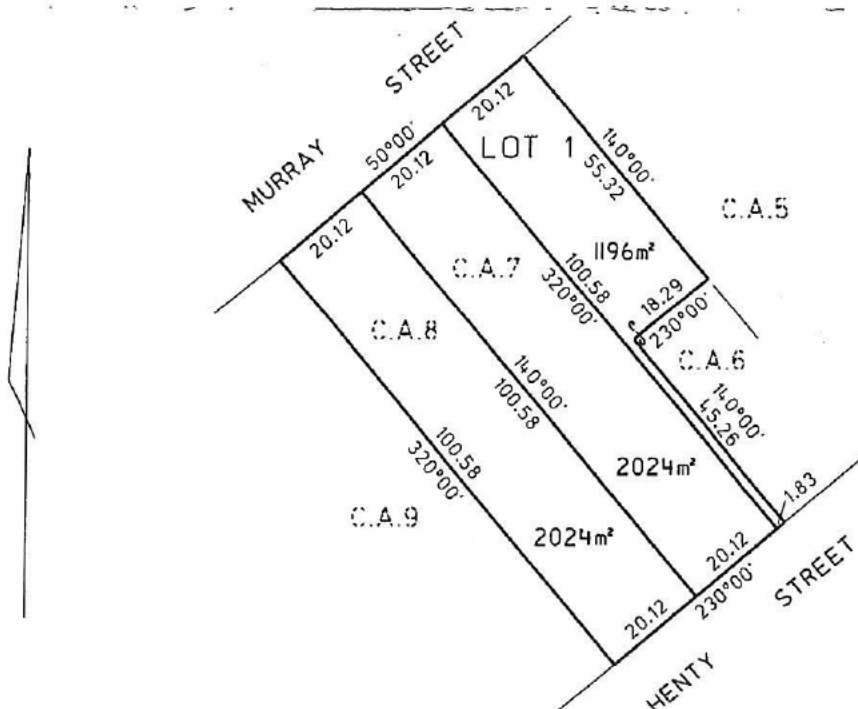

SPTP014846A-1-7

Sheet 1 of 1 sheets

10 0 10 20 50 100
LENGTHS ARE IN METRES

SHEET
SIZE
A3

APPLICATION No. :

DEALING CODE No.: 14

AP100310B